

SPECIFICATION FOR APPROVAL

Product Name	RADIAL CHOKE COIL (LEAD FREE)	Page	1
Tai-Tech Part No.	S1010-S SHIELDED SERIES		

1. CONFIGURATION & DIMENSIONS :

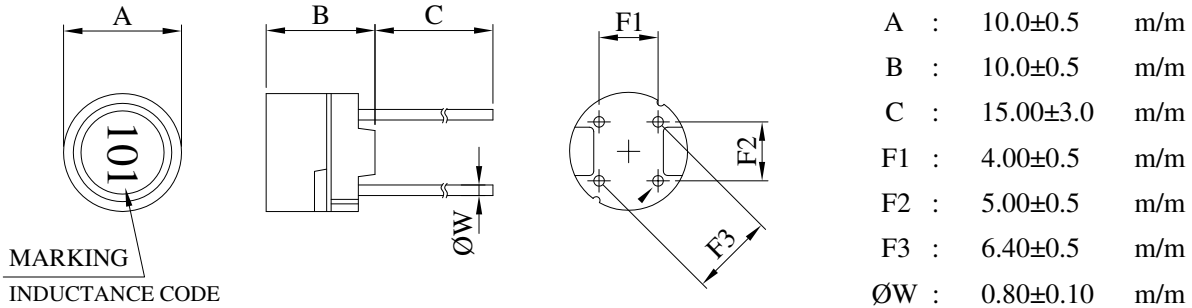

2. SCHEMATIC DIAGRAM :

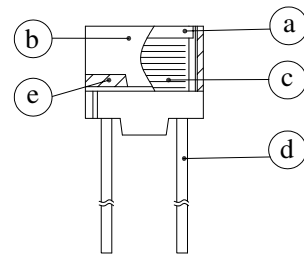
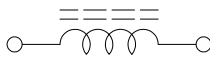

3. MATERIALS :

NO.	DESCRIPTION	SPECIFICATION	REMARK
a.	CORE	DR FERRITE CORE	
b.	CORE	RI FERRITE CORE	
c.	WIRE	ENAMELLED COPPER WIRE	
d.	LEAD	TINNED COPPER WIRE	
e.	ADHESIVE	EPOXY	

4. GENERAL SPECIFICATION :

- a. THE INDUCTANCE DROP AT RATED CURRENT IS 10% MAX.
- b. TEMP. RISE : 40°C MAX. AT RATED CURRENT.
- c. STORAGE TEMP. : -40°C ----- +125°C
- d. OPERATING TEMP. : -25°C ----- +85°C



RoHS Compliant

NOTE : Specifications subject to change without notice. Please check our website for latest information.

04.09.2006



TAI-TECH ADVANCED ELECTRONICS (S) PTE LTD

SPECIFICATION FOR APPROVAL

Product Name	RADIAL CHOKE COIL (LEAD FREE)	Page	2
Tai-Tech Part No.	S1010-S SHIELDED SERIES		

5. ELECTRICAL CHARACTERISTICS :

PART NO.	INDUCTANCE (μ H)	TEST FREQ. (HZ)	RDC (Ohm) MAX	IDC (A) MAX
S1010-100M3R5-SF	10 \pm 20%	2.52M	0.023	3.51
S1010-120M3R2-SF	12 \pm 20%	2.52M	0.024	3.24
S1010-150M2R8-SF	15 \pm 20%	2.52M	0.036	2.88
S1010-180M2R6-SF	18 \pm 20%	2.52M	0.039	2.61
S1010-220M2R3-SF	22 \pm 20%	2.52M	0.042	2.34
S1010-270M2R1-SF	27 \pm 20%	2.52M	0.045	2.16
S1010-330M1R8-SF	33 \pm 20%	2.52M	0.057	1.89
S1010-390M1R8-SF	39 \pm 20%	2.52M	0.076	1.80
S1010-470M1R6-SF	47 \pm 20%	2.52M	0.100	1.62
S1010-560K1R4-SF	56 \pm 10%	2.52M	0.110	1.44
S1010-680K1R3-SF	68 \pm 10%	2.52M	0.150	1.35
S1010-820K1R2-SF	82 \pm 10%	2.52M	0.160	1.26
S1010-101K1R0-SF	100 \pm 10%	1K	0.190	1.08
S1010-121KR99-SF	120 \pm 10%	1K	0.210	0.99
S1010-151KR90-SF	150 \pm 10%	1K	0.230	0.90
S1010-181KR82-SF	180 \pm 10%	1K	0.260	0.82
S1010-221KR74-SF	220 \pm 10%	1K	0.290	0.74
S1010-271KR67-SF	270 \pm 10%	1K	0.360	0.67
S1010-331KR61-SF	330 \pm 10%	1K	0.510	0.61
S1010-391KR55-SF	390 \pm 10%	1K	0.690	0.55
S1010-471KR51-SF	470 \pm 10%	1K	0.980	0.51
S1010-561KR46-SF	560 \pm 10%	1K	1.100	0.46
S1010-681KR42-SF	680 \pm 10%	1K	1.200	0.42
S1010-821KR38-SF	820 \pm 10%	1K	1.300	0.38
S1010-102KR35-SF	1000 \pm 10%	1K	1.500	0.35



RoHS Compliant

NOTE : Specifications subject to change without notice. Please check our website for latest information.

04.09.2006



TAI-TECH ADVANCED ELECTRONICS (S) PTE LTD

SPECIFICATION FOR APPROVAL

Product Name	RADIAL CHOKE COIL (LEAD FREE)	Page	3
Tai-Tech Part No.	S1010-S SHIELDED SERIES		

6. CHARACTERISTICS CURVES :

@ TEMP. RISE VS. DC SUPERPOSITION RESPONSE CURVE

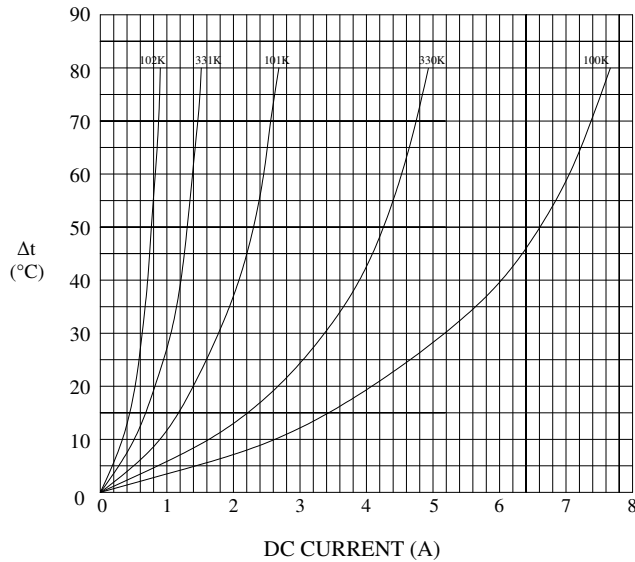

@ INDUCTANCE VS. FREQUENCY RESPONSE CURVE

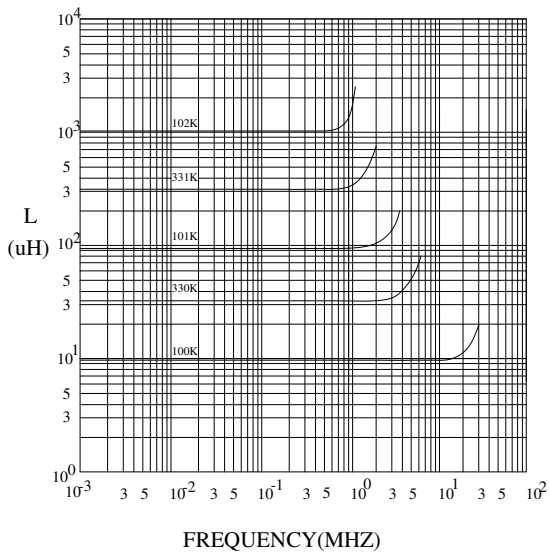

@ INDUCTANCE VS. DC SUPERPOSITION RESPONSE CURVE

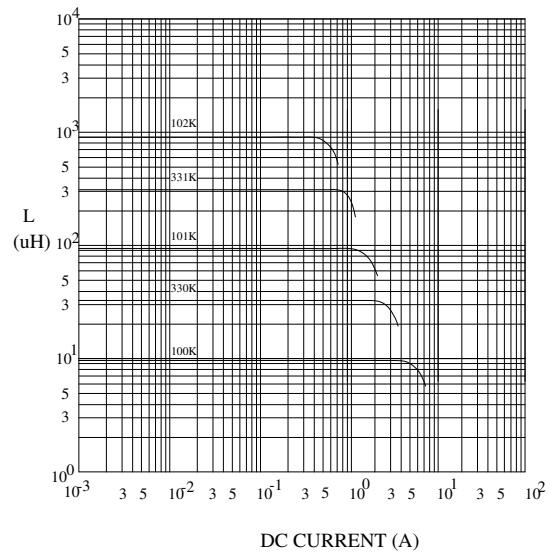

RoHS Compliant

NOTE : Specifications subject to change without notice. Please check our website for latest information.

04.09.2006



TAI-TECH ADVANCED ELECTRONICS (S) PTE LTD