

SPECIFICATION FOR APPROVAL

Product Name	RADIAL CHOKE COIL (LEAD FREE)	Page	1
Tai-Tech Part No.	S1008-S SHIELDED SERIES		

1. CONFIGURATION & DIMENSIONS :

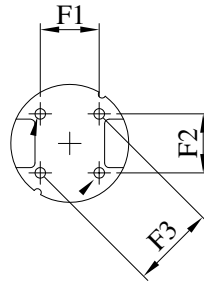
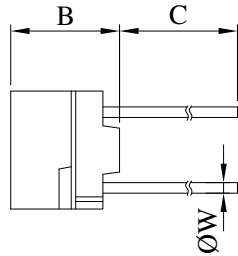
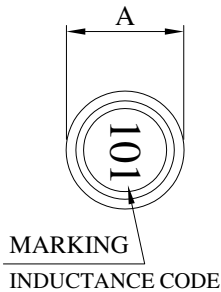

A :	10.00±0.5	m/m
B :	8.00±0.5	m/m
C :	15.00±3.0	m/m
F1 :	4.00±0.5	m/m
F2 :	5.00±0.5	m/m
F3 :	6.40±0.5	m/m
ØW :	0.80±0.10	m/m

2. SCHEMATIC DIAGRAM :

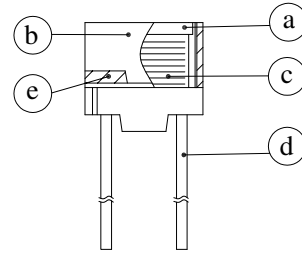
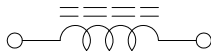

3. MATERIALS :

NO.	DESCRIPTION	SPECIFICATION	REMARK
a.	CORE	DR FERRITE CORE	
b.	CORE	RI FERRITE CORE	
c.	WIRE	ENAMELLED COPPER WIRE 2-UEW	
d.	LEAD	TINNED COPPER WIRE	
e.	ADHESIVE	EPOXY	

4. GENERAL SPECIFICATION :

- a. THE INDUCTANCE DROP AT RATED CURRENT IS 10% MAX.
- b. TEMP. RISE : 40°C MAX. AT RATED CURRENT.
- c. STORAGE TEMP. : -40°C ----- +125°C
- d. OPERATING TEMP. : -25°C ----- +85°C



RoHS Compliant

NOTE : Specifications subject to change without notice. Please check our website for latest information.

04.09.2006



TAI-TECH ADVANCED ELECTRONICS (S) PTE LTD

SPECIFICATION FOR APPROVAL

Product Name	RADIAL CHOKE COIL (LEAD FREE)	Page	2
Tai-Tech Part No.	S1008-S SHIELDED SERIES		

5. ELECTRICAL CHARACTERISTICS :

PART NO.	INDUCTANCE (μ H)	TEST FREQ. (HZ)	RDC (Ohm) MAX	IDC (A) MAX
S1008-100M2R8-SF	10 \pm 20%	2.52M	0.05	2.80
S1008-120M2R5-SF	12 \pm 20%	2.52M	0.06	2.50
S1008-150M2R3-SF	15 \pm 20%	2.52M	0.07	2.30
S1008-180M2R1-SF	18 \pm 20%	2.52M	0.08	2.10
S1008-220M2R0-SF	22 \pm 20%	2.52M	0.09	2.00
S1008-270M1R7-SF	27 \pm 20%	2.52M	0.10	1.76
S1008-330M1R6-SF	33 \pm 20%	2.52M	0.11	1.60
S1008-390M1R3-SF	39 \pm 20%	2.52M	0.12	1.38
S1008-470M1R2-SF	47 \pm 20%	2.52M	0.14	1.28
S1008-560K1R2-SF	56 \pm 10%	2.52M	0.15	1.20
S1008-680K1R0-SF	68 \pm 10%	2.52M	0.16	1.00
S1008-820KR96-SF	82 \pm 10%	2.52M	0.18	0.96
S1008-101KR92-SF	100 \pm 10%	1K	0.20	0.92
S1008-121KR80-SF	120 \pm 10%	1K	0.24	0.80
S1008-151KR73-SF	150 \pm 10%	1K	0.35	0.73
S1008-181KR64-SF	180 \pm 10%	1K	0.40	0.64
S1008-221KR61-SF	220 \pm 10%	1K	0.54	0.61
S1008-271KR56-SF	270 \pm 10%	1K	0.76	0.56
S1008-331KR50-SF	330 \pm 10%	1K	0.86	0.50
S1008-391KR44-SF	390 \pm 10%	1K	0.93	0.44
S1008-471KR41-SF	470 \pm 10%	1K	1.23	0.41
S1008-561KR38-SF	560 \pm 10%	1K	1.34	0.38
S1008-681KR34-SF	680 \pm 10%	1K	1.53	0.34
S1008-821KR32-SF	820 \pm 10%	1K	2.10	0.32
S1008-102KR28-SF	1000 \pm 10%	1K	2.30	0.28



RoHS Compliant

NOTE : Specifications subject to change without notice. Please check our website for latest information.

04.09.2006



TAI-TECH ADVANCED ELECTRONICS (S) PTE LTD

SPECIFICATION FOR APPROVAL

Product Name	RADIAL CHOKE COIL (LEAD FREE)	Page	3
Tai-Tech Part No.	S1008-S SHIELDED SERIES		

6. CHARACTERISTICS CURVES :

@ TEMP. RISE VS. DC SUPERPOSITION RESPONSE CURVE

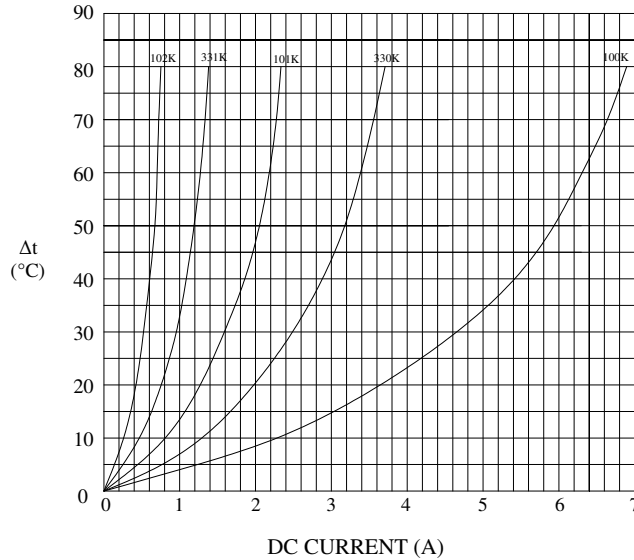

@ INDUCTANCE VS. FREQUENCY RESPONSE CURVE

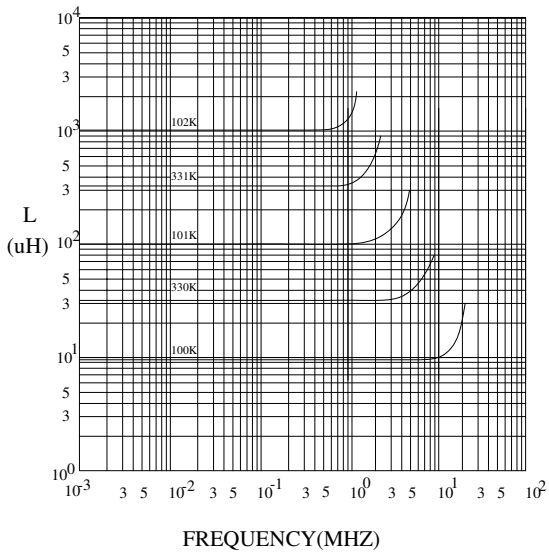

@ INDUCTANCE VS. DC SUPERPOSITION RESPONSE CURVE

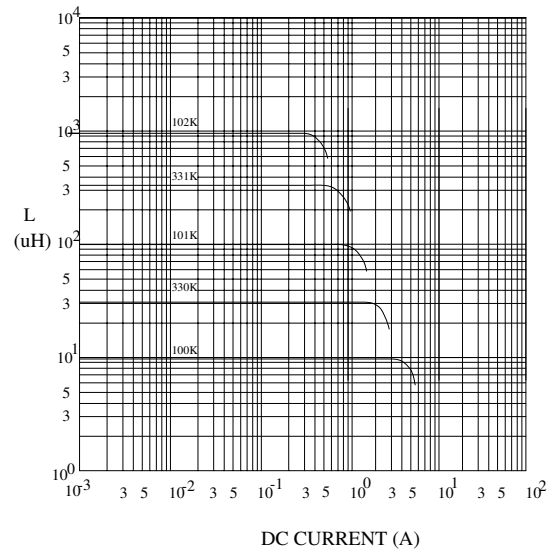

RoHS Compliant

NOTE : Specifications subject to change without notice. Please check our website for latest information.

04.09.2006



TAI-TECH ADVANCED ELECTRONICS (S) PTE LTD