

SPECIFICATION FOR APPROVAL

Product Name	RADIAL CHOKE COIL (LEAD FREE)	Page	1
Tai-Tech Part No.	S0610 STANDARD SERIES		

1. CONFIGURATION & DIMENSIONS :

MARKING :

" ● " : START

● 101----100μH (INDUCTANCE CODE)

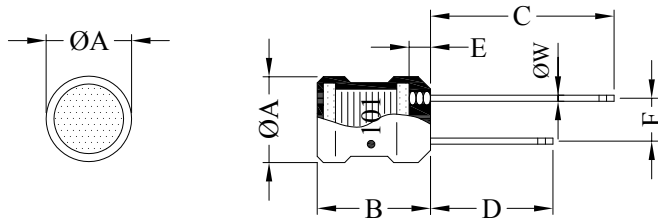

A :	6.70±0.5	m/m
B :	10.00±1.0	m/m
C :	25.00±5.0	m/m
D :	18.00±5.0	m/m
E :	2.50 MAX.	m/m
F :	3.00±0.5	m/m
ØW :	0.65±0.1	m/m

2. SCHEMATIC DIAGRAM :

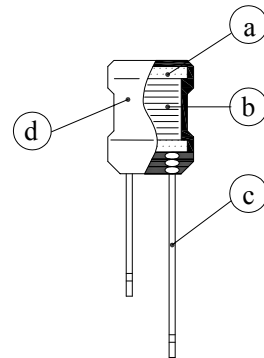
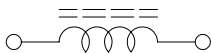

3. MATERIALS :

NO.	DESCRIPTION	SPECIFICATION	REMARK
a.	CORE	DR FERRITE CORE	
b.	WIRE	ENAMELLED COPPER WIRE	
c.	LEAD	TINNED COPPER WIRE	
d.	TUBE	SHRINKABLE TUBE	

4. GENERAL SPECIFICATION :

- a. TEMP. RISE : 20°C MAX. AT RATED CURRENT.
- b. STORAGE TEMP. : -40°C ----- +125°C
- c. OPERATING TEMP. : -25°C ----- +105°C



RoHS Compliant

NOTE : Specifications subject to change without notice. Please check our website for latest information.

22.08.2006



TAI-TECH ADVANCED ELECTRONICS (S) PTE LTD

SPECIFICATION FOR APPROVAL

Product Name	RADIAL CHOKE COIL (LEAD FREE)	Page	2
Tai-Tech Part No.	S0610 STANDARD SERIES		

5. ELECTRICAL CHARACTERISTICS :

PART NO.	INDUCTANCE (μ H)	TEST FREQ. (HZ)	Q MIN.	TEST FREQ. (HZ)	SRF (MHZ) MIN.	RDC (Ohm) MAX.	IDC (A) MAX.
S0610-100K1R1F	10 \pm 10%	1K	20	2.520M	16.0	0.07	1.10
S0610-120K1R0F	12 \pm 10%	1K	20	2.520M	12.0	0.08	1.00
S0610-150KR90F	15 \pm 10%	1K	20	2.520M	10.0	0.09	0.90
S0610-180KR75F	18 \pm 10%	1K	20	2.520M	10.0	0.10	0.75
S0610-220KR70F	22 \pm 10%	1K	20	2.520M	9.0	0.12	0.70
S0610-270KR65F	27 \pm 10%	1K	20	2.520M	8.0	0.13	0.65
S0610-330KR60F	33 \pm 10%	1K	20	2.520M	7.0	0.15	0.60
S0610-390KR55F	39 \pm 10%	1K	20	2.520M	6.0	0.16	0.55
S0610-470KR45F	47 \pm 10%	1K	20	2.520M	6.0	0.18	0.45
S0610-560KR40F	56 \pm 10%	1K	20	2.520M	5.0	0.21	0.40
S0610-680KR36F	68 \pm 10%	1K	20	2.520M	5.0	0.24	0.36
S0610-820KR34F	82 \pm 10%	1K	20	2.520M	5.0	0.35	0.34
S0610-101KR32F	100 \pm 10%	1K	20	0.796M	4.0	0.40	0.32
S0610-121KR30F	120 \pm 10%	1K	20	0.796M	4.0	0.45	0.30
S0610-151KR28F	150 \pm 10%	1K	20	0.796M	3.5	0.50	0.28
S0610-181KR26F	180 \pm 10%	1K	20	0.796M	3.0	0.75	0.26
S0610-221KR24F	220 \pm 10%	1K	20	0.796M	3.0	0.90	0.24
S0610-271KR22F	270 \pm 10%	1K	20	0.796M	2.5	1.00	0.22
S0610-331KR20F	330 \pm 10%	1K	20	0.796M	2.5	1.10	0.20
S0610-391KR18F	390 \pm 10%	1K	20	0.796M	2.0	1.20	0.18
S0610-471KR16F	470 \pm 10%	1K	20	0.796M	2.0	1.50	0.16
S0610-561KR15F	560 \pm 10%	1K	20	0.796M	2.0	1.80	0.15



RoHS Compliant

NOTE : Specifications subject to change without notice. Please check our website for latest information.



TAI-TECH ADVANCED ELECTRONICS (S) PTE LTD

22.08.2006

SPECIFICATION FOR APPROVAL

Product Name	RADIAL CHOKE COIL (LEAD FREE)	Page	3
Tai-Tech Part No.	S0610 STANDARD SERIES		

6. CHARACTERISTICS CURVES :

@ TEMP. RISE VS. DC SUPERPOSITION RESPONSE CURVE

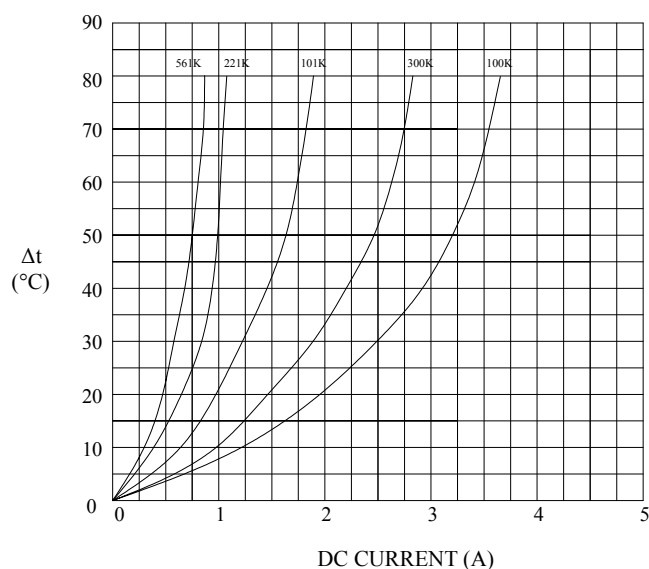

@ INDUCTANCE VS. FREQUENCY RESPONSE CURVE

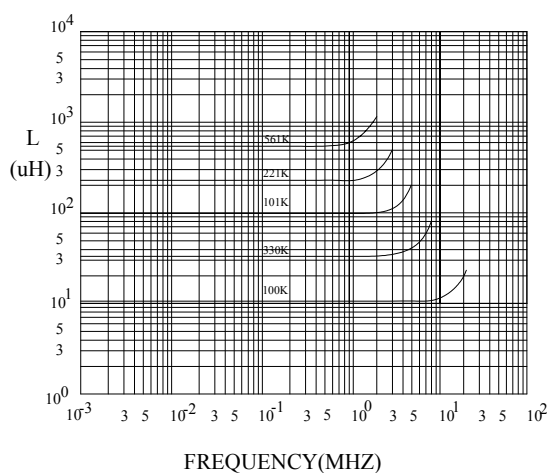

@ INDUCTANCE VS. DC SUPERPOSITION RESPONSE CURVE

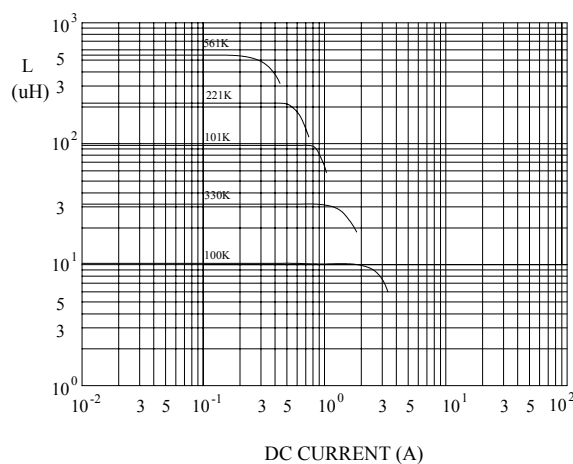

RoHS Compliant

NOTE : Specifications subject to change without notice. Please check our website for latest information.

22.08.2006



TAI-TECH ADVANCED ELECTRONICS (S) PTE LTD